

# Intelligent Door Controller



## Features

- Utilizes a standard 10/100 Ethernet connection communicate with DNA Fusion access control software.
- 6MB memory and storage for up to 240,000 cardholders and 50,000 transactions.
- Powered by PoE (IEEE Compliant 802.af) or optional external power supply.
- PoE power output for supplying power to peripheral devices such as readers and locks.
- Support for iClass, proximity, magnetic stripe, Wiegand, OSDP, OSDP Secure, RS-485 and keypad readers.
- Two reader ports available for in/out doors.
- Two programmable inputs and 2 relay outputs.
- Additional support for (16) NSC-200 network sub-controllers as well as RS-485 connected sub-controllers.
- MET Certified for UL-294 and ULC S319-05 Compliance
- Plenum-rated enclosure meets UL94-5VA flammability standard.

## DController

### Overview

The DController is a compact, IP-based, Intelligent Door Controller designed to quickly and easily add doors to your system using standard 10/100 network infrastructure. The DController supports PoE Plus to power the device as well as peripheral devices at the door and communicates with DNA Fusion™ access control software over a standard network connection thus eliminating traditional “home run” wiring to every door.

The DController is an intelligent device, meaning all cardholder and access control decisions are made locally at the device. The DController is also an extended door controller that can support up to 16 network door modules (NSC-200) and up to 8 traditional RS-485 I/O panels up to 1000 feet. The DController will support a total of 17 readers.

The DController connects directly to the network with a standard RJ45 connection and supports two readers (paired as single door), two supervised inputs, and two output relays.

# DController

## Specifications

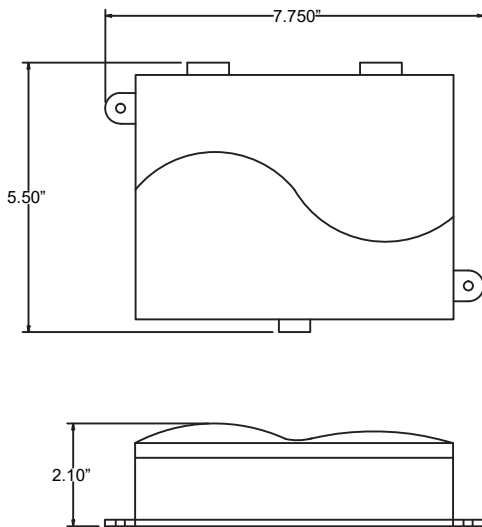

DController Dimensions



MET Certified for UL-294 & ULC S319-05 compliance and plenum-rated enclosure meets UL94-5VA flammability standard.

**Power Input:** PoE (12.95 W), compliant to IEEE 802.3af or PoE+ (25 W), compliant to IEEE 802.3at or 12 Vdc +/- 10 %, 1.8 A max.

**Power Output:** PoE: 12 Vdc @ 625 mA including reader and AUX output\*  
PoE+ or external 12 Vdc: 12 Vdc @ 1.25 A including reader and AUX output\*

**Outputs:** 2 Form C contacts 2A @ 30VDC.

**Inputs:** 2 programmable inputs, EOL 1k/1k ohm.

**Reader Power:** 12 Vdc  $\pm$  10 %: PoE, PoE+ or local power supply, 300 mA max.

**Reader Data:** Reader port 1: TTL compatible, F/2F or 2-wire RS-485

Reader port 2: TTL compatible or F/2F

**Communication:** 10Base-T/100Base-TX

**Dimension:** 7.75"L (197mm) x 5.50"W (140mm) x 2.1"H (53mm)

**Weight:** 12.8 oz. (360g) (without cables)

**Environment:**

**Temperature:** -10°C to +55°C, storage; 0°C to +40°C, operating;

**Humidity:** 10% to 95% RHNC

**Cable Requirements:**

**Power:** (External, Non-PoE) 18AWG, 1 twisted pair

**Alarm Inputs:** 1 twisted pair per input, 30-ohm max.

Reader data (TTL): 22AWG, 6 conductors, 500-foot (150 m) max.

Reader data (RS-485): 24AWG, 120-ohm impedance, twisted pair with shield, 4000ft (1,219m) max.

\* 485 Available on port 1 only

## Application

